



# Ready, Set, Go! PLAY CUBE

## Materials Used:

- Fabric from Ready, Set, Go collection by Ann Kelle for Robert Kaufman
- 12" square goose down pillow insert from Downlite

## Supplies:

- ½ yard each of 3 different fabrics or one fat quarter each of 6 different fabrics
- 4 ½ yards of purchased piping
- 12" square goose down pillow insert
- Thread to match
- Zipper or piping foot for your sewing machine

## Sewing Instructions:

Read through all steps before beginning. ½" seams are used throughout the project.

1. Cut six 13" squares from the Ready, Set, Go fabric collection
2. Plan where you want each fabric to be on the cube, and lay out and label squares like the diagram below.

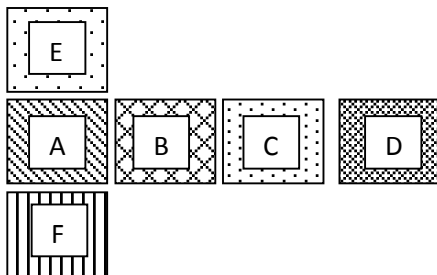

\* A, B, C, & D are the sides

\* E is the top

\* F is the bottom

3. Sew A and B together along one side, inserting piping in the seam. Leave ½" NOT sewn at the beginning and end of each seam as you put A, B, C, and D together.
4. Sew B to C, then C to D, inserting piping in each seam so that you end up with a row of squares like the diagram with piping in each seam.
5. Then sew D to A, once again inserting piping in the seam so that you have a cube without a top or bottom.

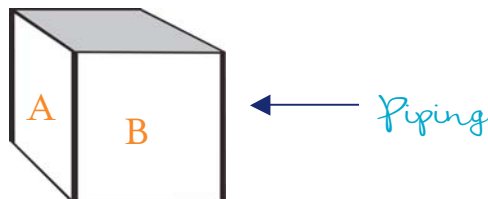

6. On pieces E and F make a small mark  $\frac{1}{2}$ " from each corner on the right side of the fabric.

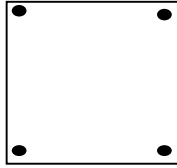

7. Starting in the about 3" from a corner, baste piping around all four sides of both E and F, making sharp right angle turns at each dot. If you make a little cut in the seam of the binding at the turn it will lie flat. Finish piping ends by joining together. See the picture below.



*Fold over the end of the fabric so that no raw edges show.*

*Clip corner of piping*

8. With the cube inside out and piece E so that the right side faces the inside of the cube, match each dot to a corner, pin at each corner and along the side. The binding will have pulled the sides of the square in some, so you will have to stretch it so that it fits.
9. Repeat step 8 with F, but only sew two adjacent sides, leave the other two sides open to put the pillow form in.
10. Hand-sew the two open sides closed.